

PMP-100GPD

BOOSTER PUMP



PMP-100GPD SPECIFICATIONS

MODEL NUMBER:	PMP-100GPD
PUMP DESIGN:	Positive displacement
DIAPHRAGM PUMP:	Three chamber
MOTOR:	Permanent magnet
VOLTAGE:	24 VDC
PRESSURE SWITCH:	None
LIQUID TEMPERATURE:	140° F (60° C) max.
PRIME:	Self-priming up to 2 meter
RUNS DRY:	WITHOUT DAMAGE
PORTS:	3/8"-18 NPT female
NET WEIGHT:	4.67 lbs (2.12 kg)
DUTY CYCLE:	Continuous
TYPICAL APPLICATIONS:	R.O. booster pump and water delivery
BYPASS:	125 psi

INLET - 8 PSI		
PRESSURE (PSI)	FLOW GPM / (L/min)	CURRENT (AMPS)
Open Flow	0.58 / 2.20	0.15
10	0.52 / 1.95	0.19
20	0.48 / 1.80	0.26
30	0.44 / 1.65	0.33
40	0.41 / 1.55	0.40
50	0.39 / 1.48	0.49
60	0.36 / 1.37	0.56
70	0.34 / 1.27	0.62
80	0.31 / 1.18	0.68
90	0.26 / 1.00	0.73
100	0.18 / 0.69	0.76
110	0.092 / 0.35	0.82
125	BY PASS	1.34

All data based on testing with water | Voltage (Volts): 24 VDC/1.5A/ Adaptor

NOTE: Performance will vary with variation in service voltage and transformer output

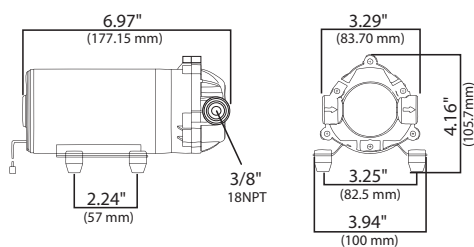

LIT-PMP-100GPD-DS 10/15/18

AQUATROL™
DIAPHRAGM PUMPS

AQUATROL | P.O. Box 2235 Chino Hills, CA 91709USA

Distributed by:

WWW.AQUATROLTECH.COM